

How to replace socket with the Saddle page 1

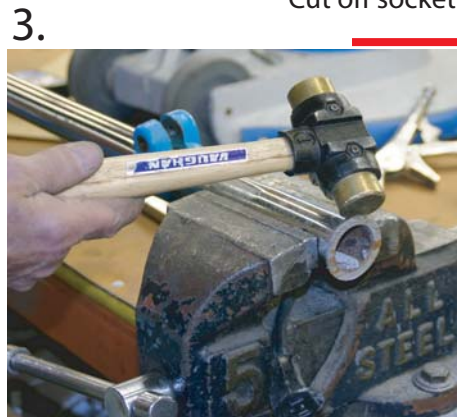

Cut off socket and

Leave 1/4" of the socket on tube.



Then knock off the left-over ring.



Insert Saddle assembly to tube opening.



Lay it flat on a bench & let it rest on a 2x4 wood. The wood will give clearance to the protruding cable.

Important. The saddle & top handle box, must be parallel.



Crimp tube very hard with a wise grip to prevent the saddle moving

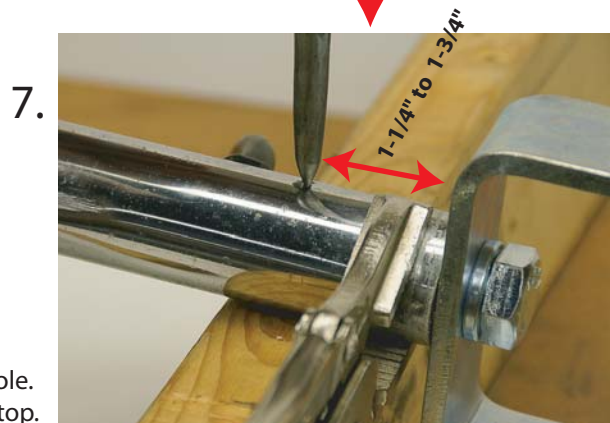

Use a center punch to mark the place of the hole.
 About 1.5" distance from the Saddle top.

How to replace socket with the Saddle page 2

8.



Drill hole (to make the hole tight use size "D" drill bit instead of 1/4" which is include in the kit)
You can drill hole parallel or 90 degree to the saddle. The choice is yours

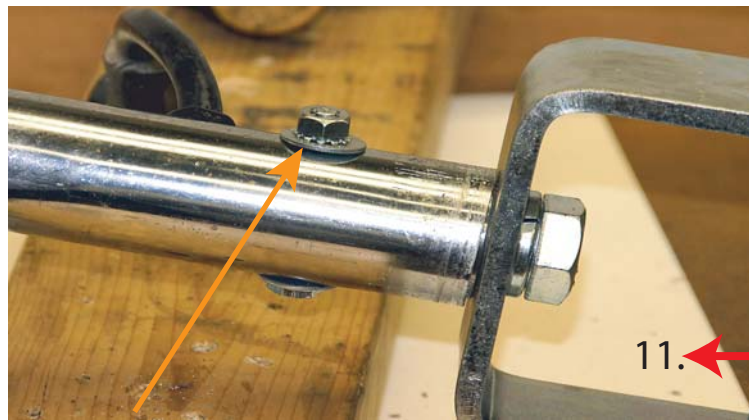

Tighten the nut then remove wise grip.

11.

9.

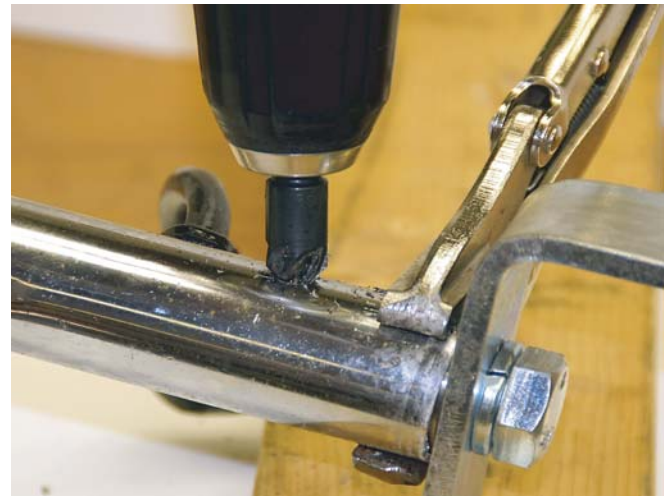

Debure hole entrance on both side
(you may use a file to remove the bur)

10.



Place 1/4" bolt in hole & add flat washer to both end of bolt.

12.

The job is finished.
Well done.

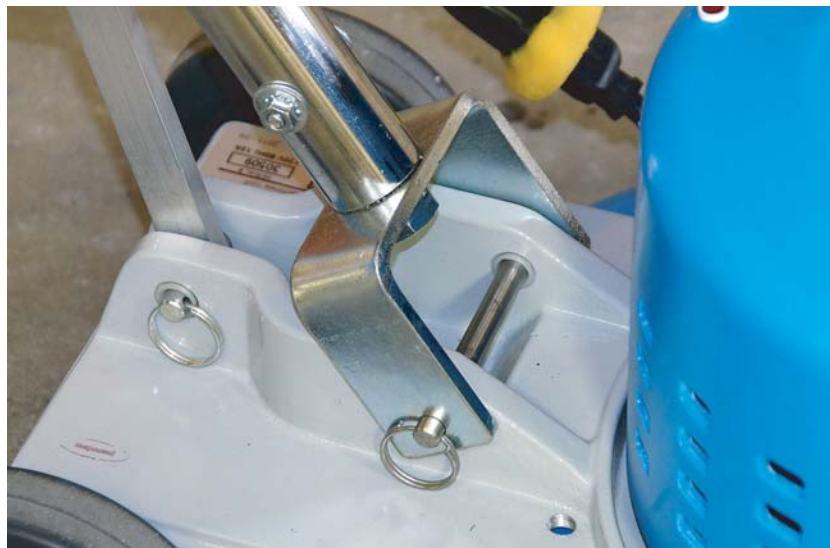

After the Saddle has been changed and if you decide to replace the bushings as well, then this is how to do it.

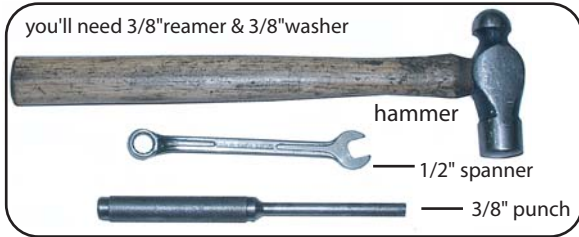

1. Tools you need

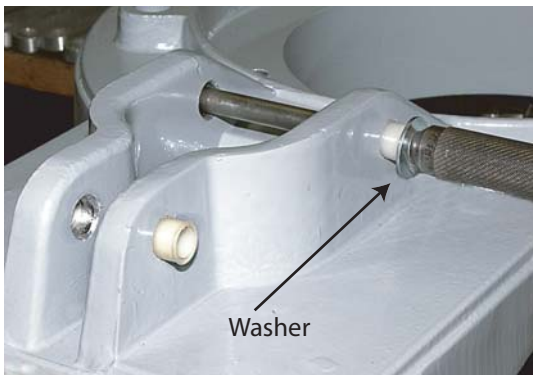

3. Place new bushings in hole & drive them in with punch and a washer ON the punch.

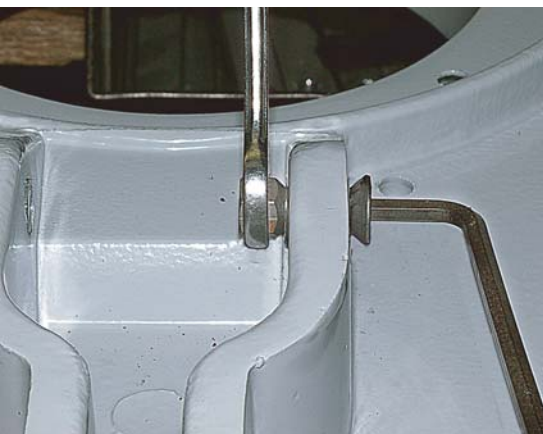

5. Flare out bushings with 5/16" screw & tapered nut. (included in kit)



2. Put base in a vise and drive out old bushings with a 12mm or 3/8" punch. (Warning. The hole size in casting is 29/64" Your 1/2" punch may get stuck in it)



4. Hammer bushing in, flush.



6. Ream it with 3/8" reamer either by hand or with drill at slow speed.