

# SL-6 (1E53126) / SL-8 (1E53164) MOTOR HEAD PARTS DIAGRAM

For Older Machines

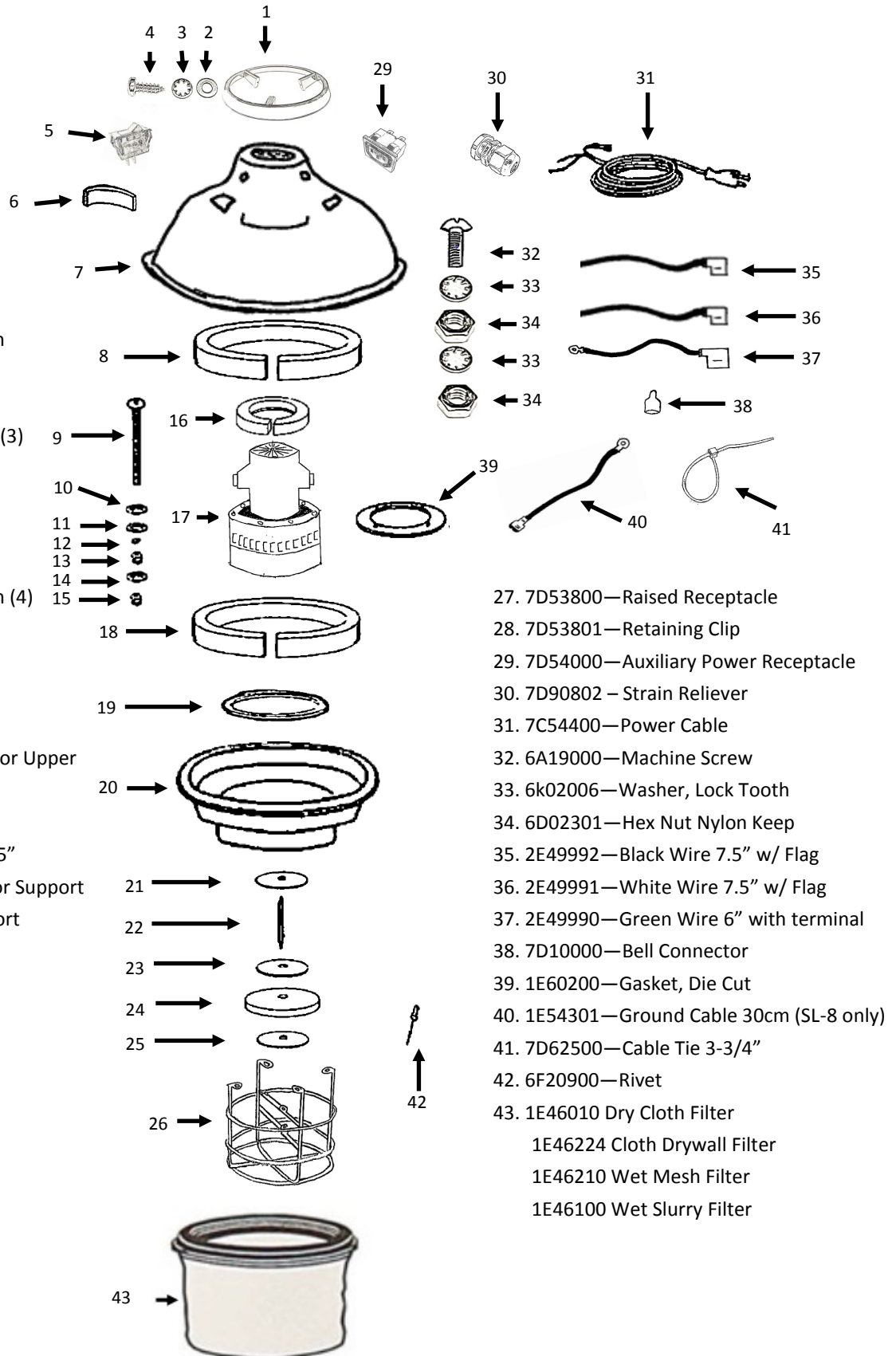
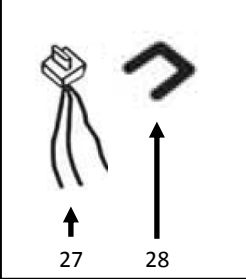

1. 1E53500—Round Handle
2. 6K02000—Flat Washer
3. 6K02006—Washer, Lock Tooth
4. 6E13400—Tapping Screw
5. 7D54100—Switch ON/OFF
6. 1E60402—Sound Absorb 8cm (3)
7. 1E53121—Motor Enclosure
8. 1E60453—Sound Absorb 25"
9. 6A20401—Machine Screw (4)
10. 6K02000—Flat Washer (4)
11. 6K02006—Washer, Lock Tooth (4)
12. 6D02300—Hex Nut (4)
13. 6D02301—Hex Nut Nylon (4)
14. 6K02000—Flat Washer (4)
15. 6D02301—Hex Nut Nylon (4)
16. 1E60400—Gasket Bi-pass Motor Upper
17. MOTOR: SL-6— 7A55700  
SL-8—7A55950
18. 1E60454—Sound Absorb 28.25"
19. 1E60300—Gasket Lower Motor Support
20. 1E56100—Lower Motor Support
21. 1E56702—Disc with Nutsert
22. 1E56500—Float Stem
23. 1E56700—Disc
24. 1E56600—Float
25. 1E56702—Disc with Nutsert
26. 1E56800—Cage

27. 7D53800—Raised Receptacle
28. 7D53801—Retaining Clip
29. 7D54000—Auxiliary Power Receptacle
30. 7D90802—Strain Reliever
31. 7C54400—Power Cable
32. 6A19000—Machine Screw
33. 6K02006—Washer, Lock Tooth
34. 6D02301—Hex Nut Nylon Keep
35. 2E49992—Black Wire 7.5" w/ Flag
36. 2E49991—White Wire 7.5" w/ Flag
37. 2E49990—Green Wire 6" with terminal
38. 7D10000—Bell Connector
39. 1E60200—Gasket, Die Cut
40. 1E54301—Ground Cable 30cm (SL-8 only)
41. 7D62500—Cable Tie 3-3/4"
42. 6F20900—Rivet
43. 1E46010 Dry Cloth Filter  
1E46224 Cloth Drywall Filter  
1E46210 Wet Mesh Filter  
1E46100 Wet Slurry Filter

# 1E48153—20L VACUUM TANK PARTS DIAGRAM

## 20L Capacity Vacuum Tank

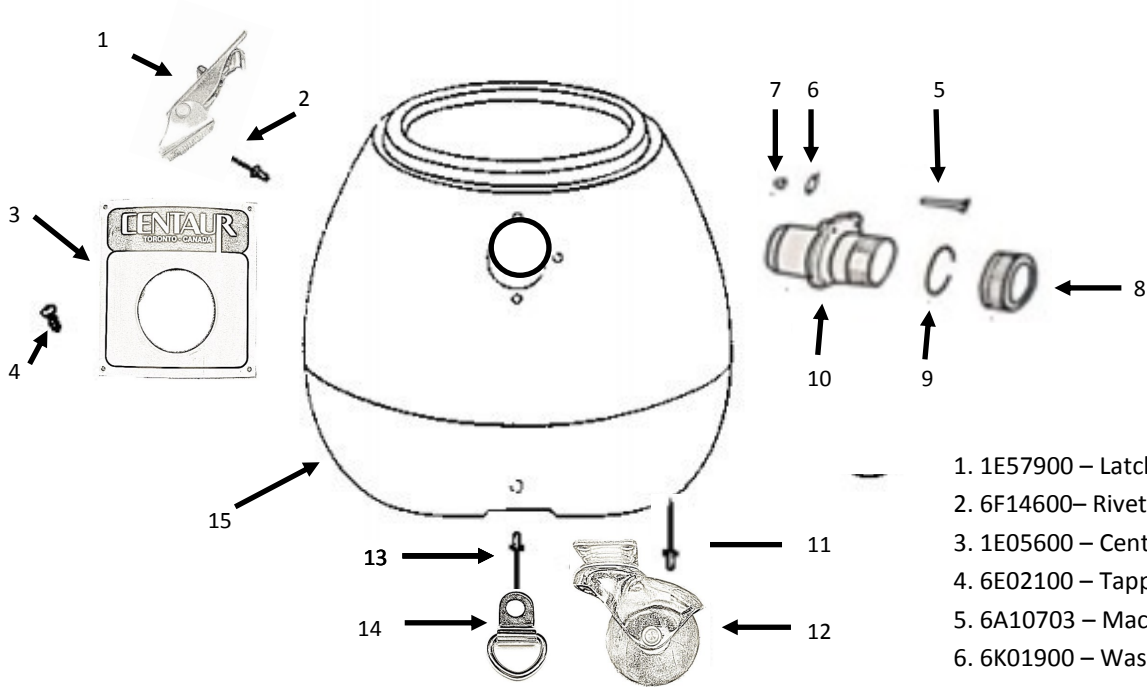

- 1. 1E57900 – Latch (2)
- 2. 6F14600– Rivet (4)
- 3. 1E05600 – Centaur Name Plate
- 4. 6E02100 – Tapping screw (4)
- 5. 6A10703 – Machine Screw (4)
- 6. 6K01900 – Washer (4)
- 7. 6D02000 – Hex Nut (4)
- 8. 1B50001 – Ribbed Nut
- 9. 1B50002 – Copper Ring
- 10. 1E57730 – Intake (with Nut & Ring)
- 11. 6F21100 – Rivet (16)
- 12. 1E57500 – Caster Wheel (4)
- 13. 6F14600 – Rivet
- 14. 1E61704 – Dee ring
- 15. 1E48103—20L Tank
- \*1E57730\* - Intake Assembly
- \*1E57735\*-Intake Assembly with mounting screws

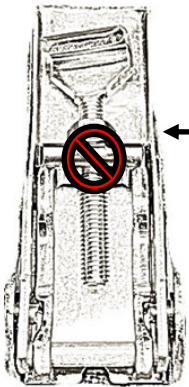

**Do not adjust latches,**  
doing so can damage  
the tank and will void  
the warranty.

